

VIKING SUN

SISTER SHIP TO AWARD-WINNING VIKING STAR

GUESTS: 930 LENGTH: 745 FT. BEAM: 94.5 FT. CLASS: SMALL SHIP



“This is one absolutely beautiful ship. Different from anything else at sea.”

– Carolyn Spencer Brown, Editor in Chief, Cruise Critic

More Al Fresco Dining Than on Any Ship

Dine al fresco surrounded by views in the Aquavit Terrace®, World Café or The Restaurant.

World Café

Multiple choices await you, from sushi to American classics and more—all in a casual atmosphere.

Infinity Pool

Swim in our glass-backed Infinity Pool cantilevered off the stern.

The Restaurant

Our main dining room features daily-changing entrées including regional specialties made with fresh, local ingredients. Our open windows provide an al fresco dining opportunity.

Alternative Restaurants

Choose from Manfredi's® Italian Restaurant, The Chef's Table, two private dining rooms or The Kitchen Table.

Dining Choices

From casual cafés and poolside grills to wine-pairing menus and regional specialties.

Green Cruising

Designed to minimize pollution with hybrid engines.

Complimentary Shipwide Wi-Fi & Business Center

So you can stay connected to the world around you.

Main Pool with Retractable Dome

For the perfect any-season swim; plus at night, catch a movie on our giant poolside screen.

The Wintergarden

This charming room near the Main Pool is perfect for relaxing and taking tea.

All Veranda Staterooms

Choose from 5 categories of spacious rooms, all with king-size beds, large showers, LCD TVs and private verandas.

Sports Deck

Perfect for staying in shape at sea.

Explorers' Lounge

With two-story panoramic windows for maximum views, this is the perfect place to relax and take in the scenery.

Mamsen's®

Our casual deli serving traditional Norwegian snacks and light fare, early morning to late night.

Explorer Suites

In premium locations with wraparound verandas for maximum views, these two-room suites are the ship's best.

Sleek, Yacht-Style Bow

An optimized hull for maximum fuel economy and speed to whisk you smoothly to your next port.

3-Deck Atrium

Designed for relaxation, intimate music performances and mingling.

Torshavn

This cabaret lounge is ideal for an after-hours drink.

Full 360° Promenade Deck

The perfect place for walking or jogging on our ¼-mile continuous loop track.

Underwater Stabilizers

Ensure smooth sailing regardless of weather.

The Spa Experience

Try the ultimate healthy Scandinavian tradition with our Snow Grotto and sauna; or a massage in The Spa.

The Theater & 2 Cinemas

Our main theater, plus 2 movie theaters—the perfect venues for lectures or to watch movies.

SERENE SCANDINAVIAN SPACES

Every room a living room

EXPAND YOUR HORIZONS on elegant, intimate ships, thoughtfully designed by experienced nautical architects and designers to help you connect with your destination in every way.

When we set out to *reinvent the ocean cruise*, we reimagined our ships completely—from the inside out—with graceful rooms designed for your comfort and serenity. We have no casino or kiddie pools; instead we created open, light-filled spaces to inspire and refresh you along your journey.

We have designed our ships down to the most minute detail—from the serene Wintergarden, perfect for a calming cup of tea; to our Scandinavian-inspired Spa, a Nordic sanctuary of wellness; to the Explorers' Lounge, where you can share your latest adventures with fellow travelers as you *take in spectacular approaches* to the Geirangerfjord or the cascading temperate rainforests of Alaska's Inside Passage.

ART, LITERATURE & HERITAGE INFUSE YOUR EVERY MOMENT. Our elegant spaces are complemented by a thoughtfully curated onboard collection of art, literature and vestiges of history.

- Peruse *classic and contemporary paintings, sculptures and photographs* by esteemed Scandinavian artists.
- See one of the largest collection of works by master Expressionist *Edvard Munch* outside of Oslo's Munch Museum.
- Admire the richly textured *Bayeux Tapestry* which tells the story of the Battle of Hastings and the Vikings' connection to this significant event.
- Enjoy our *Met Under the Stars*, select showings of the Metropolitan Opera's magnificent performances.
- In our *well-curated Library*, select from a broad range of titles from history to architecture.
- Visit the *Viking Heritage exhibit* to browse replicas of tools and clothing from the Viking Age.
- Gain invaluable insight into *the rich history of your destination* from our *onboard Viking Resident Historian*
- Our *Viking Art Guide app* enhances your experience further with insightful commentary about our onboard art and unique Scandinavian spaces.

Viking Star is one of the “most luxurious and design-forward vessels sailing today.”

– Andrew Sessa, Architectural Digest





THE SPA

MAKE RELAXATION AN INTEGRAL PART OF YOUR JOURNEY. We offer you more than just a pool and spa: We've re-created the Scandinavian bathing ritual with an elegant touch, resulting in the most unique experience at sea. Take a dip in our *Infinity Pool*, set at the ship's stern with stunning views. Alternately, enjoy the perfect swim in any weather under the *Main Pool's retractable roof*. At *The Spa*, treat yourself to holistic wellness. As our guest, renew your body and spirit in our complimentary hot sauna or thermal pool, then step into our Snow Grotto, a sanctuary of gentle snowfall and chilled air. If you wish, you may indulge in a soothing massage, facial or other treatment from LivNordic, Scandinavia's leading spa, right on board. It's the ideal way to begin or end a day of exploration.

“The Spa is expansive and beautifully designed.”

– Berlitz Cruising & Cruise Ships 2016

MAIN POOL



PENTHOUSE JUNIOR SUITE

ALL VERANDA STATEROOMS

Every day a new vista

THE PERFECT RETREAT to relax and begin your day refreshed. Indulge in a morning cup of coffee on your private veranda. Unwind on the couch with your favorite book. More than just a place to sleep, each stateroom is an *open and airy sanctuary* with a *sweeping view* of your destination. From Veranda Staterooms to our spacious two-room Explorer Suites, you will find a beautifully designed, *streamlined Scandinavian interior*, well appointed in the understated elegance and contemporary comfort for which Viking is known.

All staterooms include premium amenities: king-size Viking Explorer bed with luxury linens, large flat-screen LCD TV, large glass-enclosed shower, heated bathroom floor, direct-dial satellite phone and cell service, security safe, hair dryer, 110/220 volt outlets, ample USB ports, Wi-Fi, interactive TV with complimentary movies and 24-hour room service.

STATEROOM AMENITIES & LAYOUTS

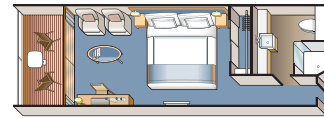

(V) VERANDA: 270 SQ. FT.

- M stateroom access
- Priority shore excursion reservations (60 days prior to departure)
- Mini-bar with soft drinks, water & snacks

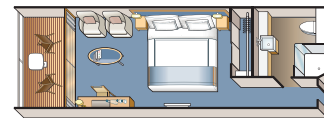

(DV) DELUXE VERANDA: 270 SQ. FT.

- M stateroom access
- Priority shore excursion reservations (67 days prior to departure)
- 1 guaranteed priority reservation at each alternative restaurant (60 days prior to departure)
- Mini-bar with soft drinks, water & snacks replenished once daily
- n-suite binoculars, coffee & cashmere blanket

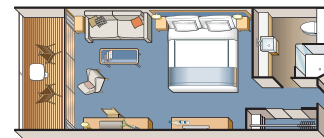

(PV) PENTHOUSE VERANDA: 338 SQ. FT.

- M stateroom access
- Priority shore excursion reservations (77 days prior to departure)
- 2 guaranteed priority reservation at each alternative restaurant (70 days prior to departure)
- Mini-bar with alcoholic beverages, soft drinks water & snacks, replenished once daily
- n-suite binoculars, coffee & cashmere blanket
- shoe shine & pressing service
- bottle of champagne

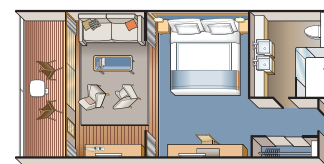

(PS) PENTHOUSE JUNIOR SUITE: 405 SQ. FT.

- 1 AM priority stateroom access
- Priority shore excursion reservations (87 days prior to departure)
- 3 guaranteed priority reservation at each alternative restaurant (80 days prior to departure)
- Mini-bar with alcoholic beverages, soft drinks water & snacks, replenished once daily
- In-suite binoculars, coffee & cashmere blanket
- Laundry, dry cleaning, shoe shine & pressing service
- bottle of champagne

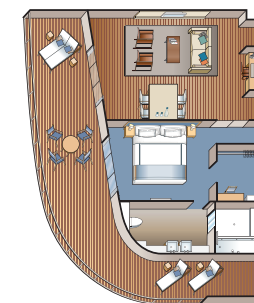

(ES) EXPLORER SUITE: 757–1,163 SQ. FT.

A true two-room suite

- 11 AM priority stateroom access
- Priority shore excursion reservation (97 days prior to departure)
- 3 guaranteed priority reservation at each alternative restaurant (90 days prior to departure)
- Mini-bar with alcoholic beverages, soft drinks water & snacks, replenished once daily
- In-suite binoculars, coffee & cashmere blanket
- Laundry, dry cleaning, shoe shine & pressing service
- Bottle of champagne

Stateroom configuration varies depending upon location on each deck. Diagram not to relative scale.

(OS) OWNER'S SUITE: 1,448 SQ. FT. A lavish and expansive home away from home, the Owner's Suite pampers guests with the most luxurious accommodations and amenities on board.



AWARD-WINNING BATHROOMS, EXPLORER SUITE

THE FINE ART OF DETAIL. Thoughtful touches ensure unrivaled comfort, from bed to bath. Indulge in king-size beds with crisp linens, soft duvets and bed throws of intricate Marius weave. Get the perfect night's sleep on therapeutic, *goose-down pillows*. Enjoy *generously proportioned closets*, a flat-screen LCD TV with an interactive system and complimentary programming, and leather wastebaskets. Choose from *nine outlets accommodating USB ports and US/IEU prongs and convenient switches that direct your lighting*. In our *award-winning bathrooms*, luxuriate in a large glass-enclosed shower with strong water pressure and easy-to-see controls; enjoy double sinks, anti-fog mirrors, heated floors and generous storage; and treat yourself to luxury robes, slippers and *premium Freyja® toiletries*.

Walls are graced with *drawings by Chinese children who attend schools supported by Viking*. The talented youngsters drew the images from photographs depicting *scenes from Bergen, Dubrovnik, Copenhagen, Monte Carlo, Barcelona* and all destinations to which Viking travels.

TOP LEFT: PREMIUM BATH PRODUCTS; TOP RIGHT: LUXURY LINENS ATOP KING-SIZE BEDS
BOTTOM LEFT: TRADITIONAL MARIUS WEAVE BED THROWS; BOTTOM RIGHT: ARTWORK INSPIRED BY VIKING PORTS



AQUAVIT TERRACE & INFINITY POOL

DESTINATION-FOCUSED DINING

The most al fresco dining at sea

AT VIKING, WE CELEBRATE DINING BOTH ON SHORE AND ON OUR SHIPS. *Viking Sun* puts the spotlight on fine dining in The Restaurant, which serves three full meals and the widest choice of culinary options. Our alternative restaurants—the World Café, The Chef's Table and Manfredi's Italian Restaurant—serve both *regional specialties and American classics*. Imagine sampling authentic dim sum in The Restaurant while gazing upon Hong Kong's Victoria Harbor through windows that open to bring in your destination. Or sipping Darjeeling tea and savoring chicken tikka masala as you glide along India's breathtaking coast. Or ending your day with assorted Norwegian smørbrød and split pea soup at Mamsen's, our traditional Scandinavian deli serving light meals based on Mamsen's own recipes.

Whatever your tastes, dining is more than just a meal, *it's part of your journey.*



TOP LEFT: WORLD CAFÉ; TOP RIGHT: THE RESTAURANT; BOTTOM: AQUAVIT TERRACE



REGIONAL DISHES, FRESH LOCAL INGREDIENTS

SO MUCH TO SAVOR. Few things say as much about a culture as its cuisine. Regional dishes from market to table at The Kitchen Table. Freshly prepared pastas and Chianti by the carafe at Manfredi's. A multicourse tasting menu complete with wine pairings at The Chef's Table. International fare at the World Café. Gourmet burgers at the Pool Grill. Afternoon tea and scones at the Wintergarden. Vintage wines available at the Viking Bar or with your meals. And rare Armagnacs in Torshavn. With so many onboard dining and imbibing opportunities, there is something to please every palate.



TOP LEFT: GJETOST ON HEART-SHAPED NORWEGIAN WAFFLES; TOP RIGHT: TORSHAVN VINTAGE ARMAGNACS
BOTTOM LEFT: CHEF ANTHONY & CHAIRMAN TORSTEIN HAGEN; BOTTOM RIGHT: CHAIRMAN'S CHOICE, NORWEGIAN POACHED SALMON

